

## TUMBLE DRYERS

**DX**  
RANGE

DX 55	DX 77	DX 90
55KG 120LB	77KG 170LB	90KG 200LB



### FEATURES

- Controls:
  - Dual Digital Control or OPL Micro
- Gas, Steam heating, Electrical heating (DX55)
- Large door opening for easy loading and unloading (Ø 68cm)
- Galvanized drum
- Radial airflow
- Standard reversing drum
- Self-cleaning lint screen
- Preheating of intake air

### OPTIONS

- Stainless steel drum
- Stainless steel front panel with black painted door
- Residual moisture control Sensodry+®:
  - lower energy and utility costs
  - lower linen replacement costs
- SafeTech™ Fire Suppression System

senso.dry+

SafeTech™



FAST DRYING



LOW ENERGY  
CONSUMPTION



LARGE DOOR  
OPENING

GET AHEAD IN LAUNDRY



PT. TRIGLOBAL MANDIRI INDONESIA  
Laundry Machines Contractors and Supplier

TYPE		DX55	DX77	DX90
<b>CAPACITY</b>				
Drum capacity 1:18	kg/lb	57/126	78/172	92/203
Drum capacity 1:22	kg/lb	46/101	64/141	75/165
Drum volume	l	1020	1410	1660
Drum diameter	mm	Ø 1120	Ø 1290	Ø 1290
<b>AIRFLOW</b>				
Airflow	l/s	660	1010	1010
<b>DRYING AVERAGE</b>				
Gas heating	g/min	979	1401	1673
Electric heating	g/min	698	-	-
<b>MOTOR</b>				
Fan	kW	1,1	1,1	1,1
Drive	kW	1,1	1,1	1,1
<b>GAS HEATING</b>				
Energy	kW	79	116	125
Energy	kBTU/h	270	395	425
Electrical connection		3x 200-240V/50-60Hz, 3x 440-480V/50-60Hz, 3x 380-415V/50-60Hz		
Gas connection	NPT	1"	1"	1"
<b>STEAM HEATING</b>				
High pressure 6,9 bar	kW	54,95	77,81	77,81
	kBTU/h	187,5	265,5	265,5
Electrical connection		3x200-240V/50-60Hz, 3x440-480V/50-60Hz, 3x380-415V/50-60Hz		
Steam connection	NPT	¾"	¾"	¾"
<b>ELECTRICAL HEATING</b>				
Energy	kW	60	-	-
Electrical connection		3x230-240V/50-60Hz 3x380V/50-60Hz 3x400-415V/50-60Hz 3x440V/50-60Hz 3x460-480V/50-60Hz		
<b>EXHAUST</b>				
	Ø /mm	254	305	305
<b>DIMENSIONS</b>				
Size H×W×D	mm	2175×1170×1725	2390×1345×1775	2390×1345×1965
Net weight (E, G, S)	kg	565, 555, 605	- , 635, 705	- , 705, 770
<b>TRANSPORT DATA</b>				
Packed (foil) H×W×D	mm	2290×1220×1820	2510×1320×1870	2510×1320×2070
Gross weight (foil,E,G,S)	kg	600, 585, 635	- , 670, 740	- , 740, 805
Packed (crate) H×W×D	mm	2310×1350×1890	2550×1530×1950	2550×1530×2140
Gross weight (crate,E,G,S)	kg	675, 660, 710	- , 755, 825	- , 825, 895

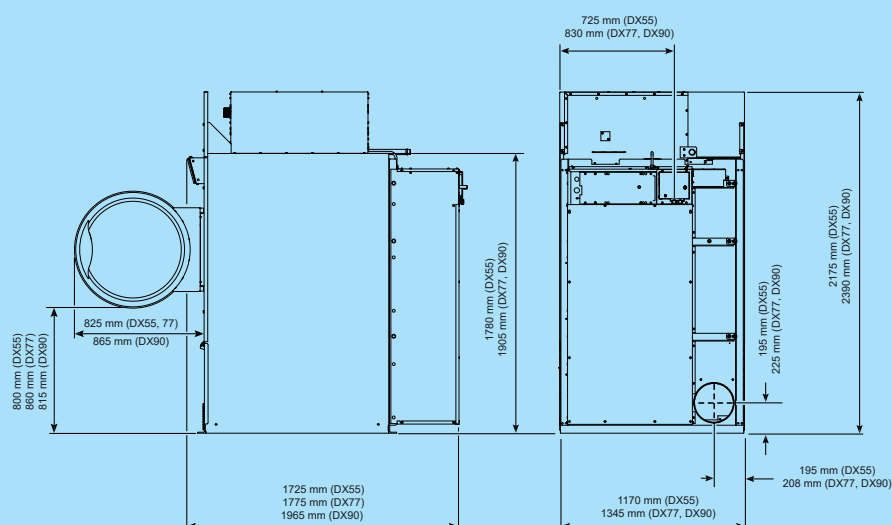

The Primus preserves the right to change the machines and the specification in this leaflet at any time, without prior notice. Details and photographs are only for information and never binding.

[www.primuslaundry.com](http://www.primuslaundry.com)



Primus by Alliance Laundry Systems